

Courses and Distances Down
the River from Hemk. to
Post

- S 33W - 35
- N 76W - 26
- N 88W - 15
- N 15W - 4
- N 15E - 14
- N 2E - 16
- N 16W - 18
- N 31W - 28
- North - 18
- N 24W - 12
- N 55W - 10
- N 72W - 12
- N 73W - 56
- S 73W - 8
- N 63W - 18
- N 29W - 10
- N 9W - 39
- N 8E - 6
- N 31E - 45
- N 57E - 28
- N 74E - 20
- N 85E - 45
- N 77E - 50
- N 65E - 102
- N 50E - $\frac{9}{588}$ to Post

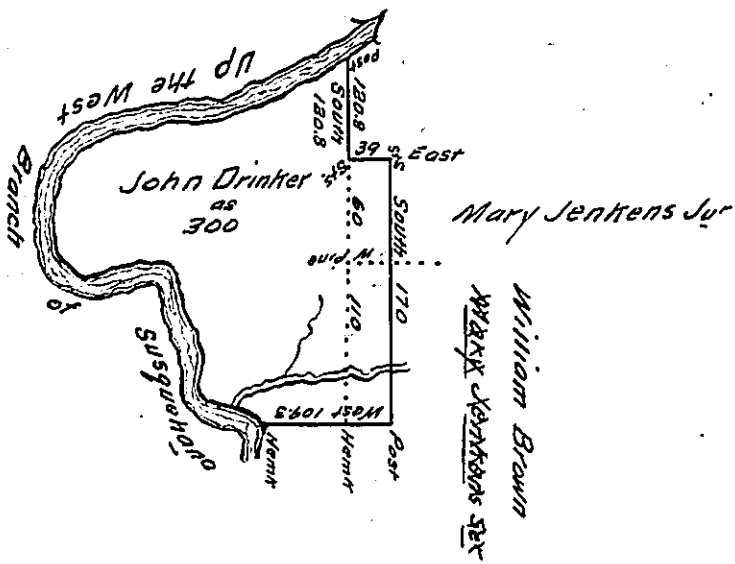

Draught of a Tract of Land Situat. in Chest Township

Clearfield County on the South Side of the West Branch of the Susquehanna River Containing Three Hundred Acres and the Usual Allowance of Six per Cent for Roads &c. Surveyed the 25th Day of Sept. 1828 in Pursuance of a Warrant Dated 6th Day of August 1773 Granted to John Drinker for 300 Acres

To Gabriel Heister Esq.

David Ferguson

Surveyor General

Note the above Survey Interferes 13-33^{as ps} with Mary Jenkins Jur and 25-136^{as ps}

with William Brown and occupied by George Achison Mary Jenkins Jur.

Part^{al} Warrant Dated 3rd August 1773 Surveyed 1828 William Brown D.D.F.

Partialy Survey Surveyed part of a Body

IN TESTIMONY that the above is a copy of the original remaining on file in the Department of Internal Affairs of Pennsylvania, made conformably to an Act of Assembly approved the 16th day of February, 1833, I have hereunto set my Hand and caused the Seal of said Department to be affixed at Harrisburg, this *Eighteenth* day of *January* 1909

Henry Howe
Secretary of Internal Affairs.